

© Ordnance Survey Ireland. All rights reserved. Licence number 2010/20 CCMA/ Sligo County Council

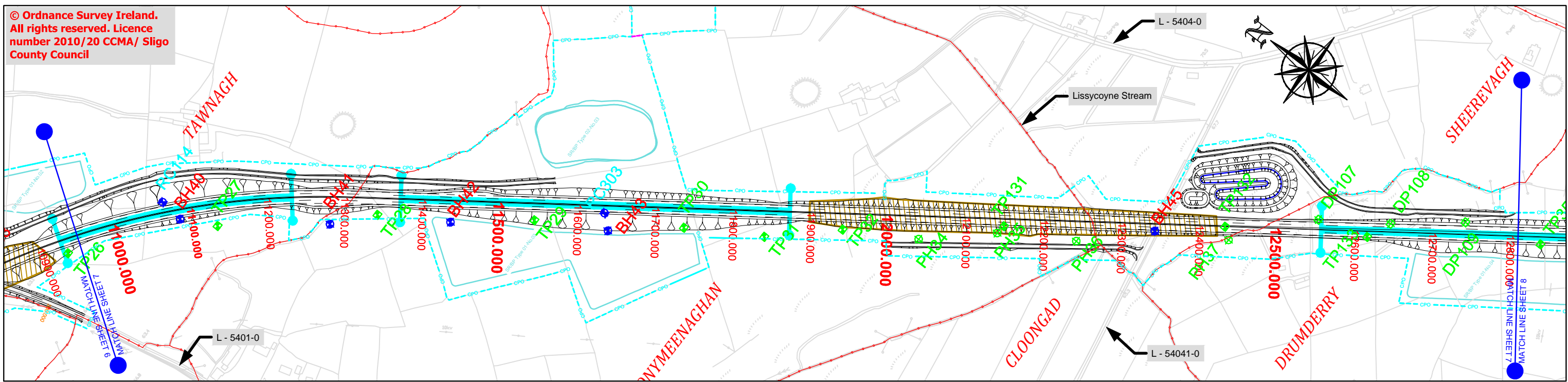

For the purposes of Impact Assessment. The results of the Geobore S Corehole are considered more reliable than the adjacent conventional rotary coreholes and are used for interpretation in this regard.

For the purposes of Impact Assessment. The results of the Geobore S Corehole are considered more reliable than the adjacent conventional rotary coreholes and are used for interpretation in this regard.

Probes shown at selective locations only for indicative purposes

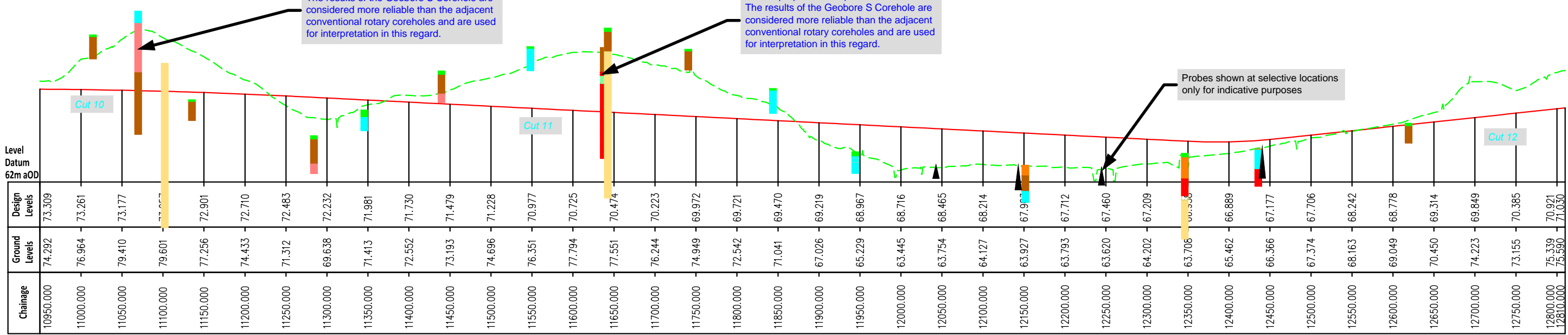

Legend

Geotechnical

- Borehole (BH indicates Borehole, RC indicates Rotary Core, Borehole with Standpipe)
- Trial Pit
- Probe Hole

G.I. Classification Overview (based on main class)

TOPSOIL	BEDROCK
TOPSOIL	GRAVEL
TILL	SAND
BOULDERS	SILT
CLAY	PEAT
COBBLES	PEAT

PROBE (selective locations only)

- Indicates depth of refusal

Nb.: Alluvials identified in localised locations included in categorisations and not specifically defined in the sections.

- Townland Boundary
- CPO Boundary
- Land Made Available (LMA)
- Townland Names
- Design Chainage
- Retaining Wall
- Constructed Wetland
- Existing Attenuation Pond
- Cut Section (based on road centre line)
- Spoil Repository
- Landscape Mitigation Site
- Excavate/Replace for the purposes of EIS
- Geometrics Details
- Proposed Design Level
- Existing Ground Level

NOTE:
All proposed road levels indicated are based on a Design prepared for Phase 3 and 4 of the NRA PMG and may be revised at the Detailed Design Stage. Modifications may be made to avail of opportunities to improve the design in the light of experience on the ground or other innovations provided this has no significant adverse environmental effects.

G.I Classification overview is for indicative purposes only (to give a broad overview of geological conditions).

Nb.: Where GI points are not flush with existing GL this is an indication of the point being some distance off the centreline of the proposed N4.



National Road Design Department
Sligo County Council
Business Centre, Market Yard, Sligo, Ireland
Tel: 071 91-11975;
e-mail: fmechan@sligococo.ie



Date	By	Revision

Project N4 Collooney to Castlebaldwin Proposed Road Development

Title Geotechnical Overview
Ch. 10,950m to Ch. 12,810m

Scales (①A3) H 1:5,000 V 1:500	Date December 2013	Job No. SO/01/150
Design FM	Drawn BR	Checked FM
		Approved AS

Figure No.: Fig.: 13.47
Sheet 7 of 8